

### Bus Stands

Stand	Route
1	480
	904 Train replacement to Butler Stn
2	482
3	Set Down
	904 Train replacement to Perth
4	483
5	484
6	471, 474, 481
	School Specials

### Legend

North Point	Bus Stand Number	Toilets - Male & Female Accessible	Transperth Parking	Stairs	Road	Principal Shared Path
	Walking/Accessible Path			Escalator	Pathways	Busway
	Pedestrian Access			Lift	Non-Accessible Area	
					Platform	
					Concourse & Ramp	

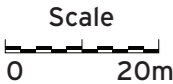

Trains to Butler →  
← Trains to Perth

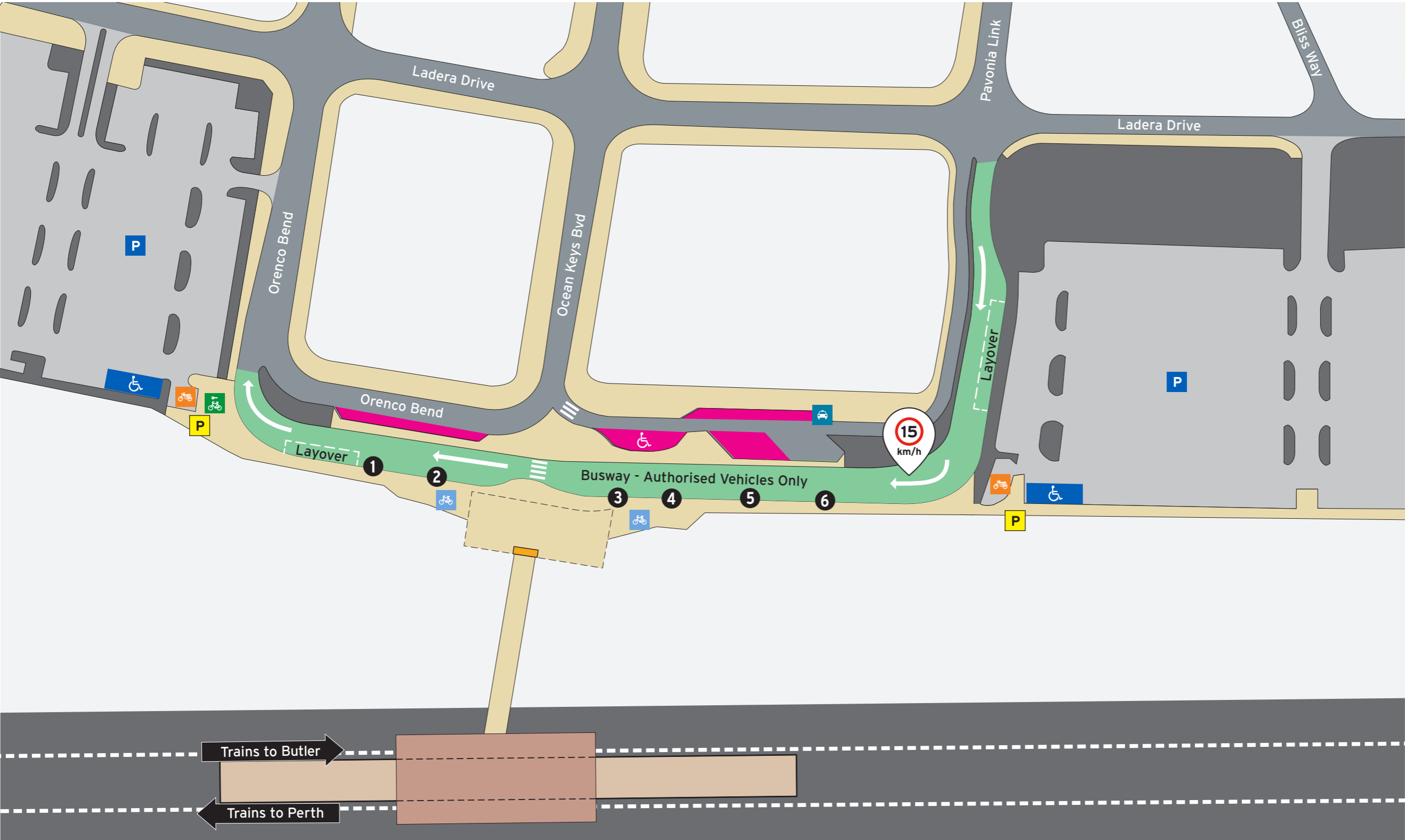

**P | Parking Information**

---

**When to pay**

**Operating Times**

Monday-Friday Fee applies  
 Saturday No charge  
 Sunday or Public Holiday No charge\*

\*Unless vehicle is parked overnight

---

\$2.00 per 24hr period or part there of applies.

This parking charge applies to all vehicles.

For more information on parking your vehicle visit [transperth.wa.gov.au](https://transperth.wa.gov.au)

**Legend**

- |             |                           |                     |              |                     |                       |
|-------------|---------------------------|---------------------|--------------|---------------------|-----------------------|
| North Point | <b>1</b> Bus Stand Number | Transperth Parking  | Bike Shelter | Road                | Principal Shared Path |
|             |                           | ACROD Parking       | Motorbikes   | Pathways            | Busway                |
|             |                           | SmartParker Machine | Bike U-rails | Non-Accessible Area |                       |
|             |                           | Short Term Parking  | Taxi         | Platform            |                       |
|             |                           |                     |              | Concourse & Ramp    |                       |